

5



USB

Overview of USB Operations

This section explains the basic operations in USB mode.

Saving the Scanned Data to a USB Flash Drive

You can save the scanned data to a USB flash drive.

- 1 Insert a USB flash drive into the USB slot.

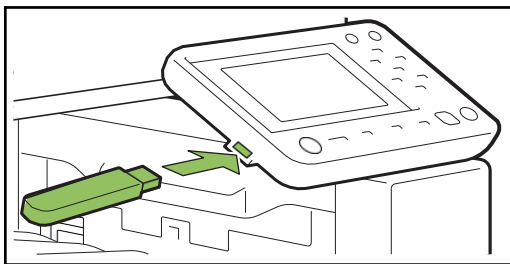

- 2 Load the original.

For more information on the types of originals that can be used, see "Originals" in the "Safety Information".

■ In the ADF

- 1 Load the original in the ADF.

Align the originals and place them face up.

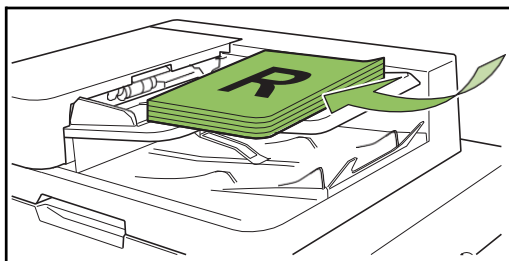

- 2 Slide the original guides to match the width of the originals.

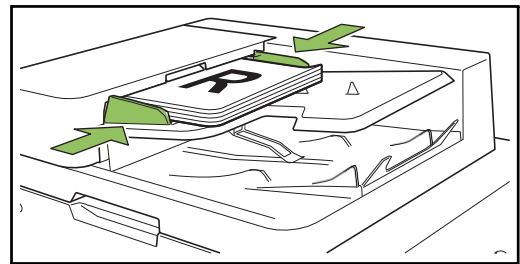

■ On the Platen Glass

- 1 Open the original cover.
- 2 Load the original.

Load the original face down on the glass. Align the corner of the original with the upper-left corner of the glass.

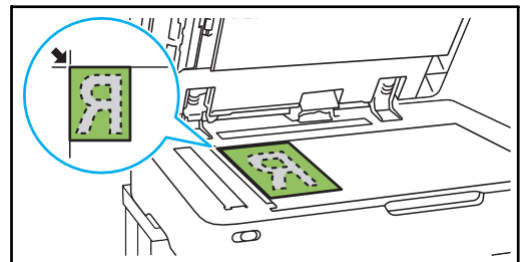

- 3 Close the original cover.



• Open and close the original cover gently.

- 3 Select [USB] - [Save] on the [Home] screen.

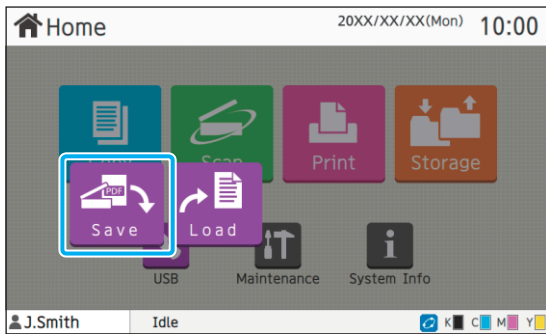

- 4 Change the settings.

Specify the detailed settings for scanning. For more information on the functions that can be configured, see "List of Settings in [USB] - [Save]" (p. 5-4).

- 5 Press the [Start] key.

Printing a Document Saved on a USB Flash Drive

You can print a document that is saved on a USB flash drive.

For specific instructions on how to save a document to a USB flash drive, see "Output and Destination" (p. 3-12) in "Print".



- Only PRN-format files can be printed.
- A PRN file is a dedicated file format in which data is output via the printer driver. This type of file can only be opened on a RISO printer or application.
- If you are using the optional PostScript kit, you can also use PDF files. For more information, see "Printable Files in the USB Flash Drive" (p. 8-37) in "Optional Equipment".

- 1 Insert a USB flash drive into the USB slot.

- 2 Select [USB] - [Load] on the [Home] screen.

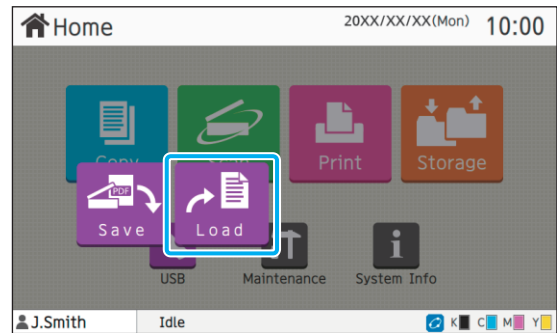

- 3 Select the folder that you want to use and touch [Open].

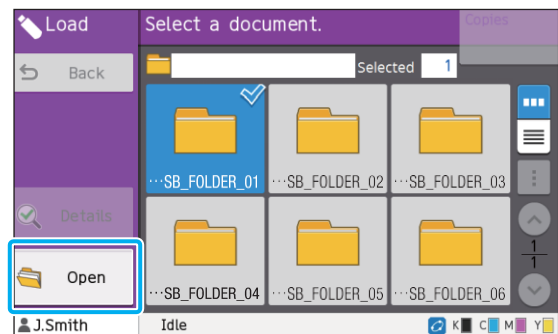

5

- 4 Select the document that you want to print.

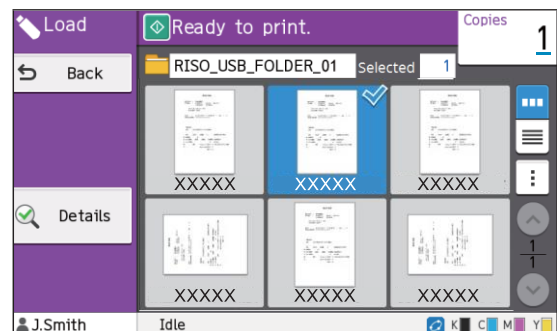

The selected document has a check mark.

- 5 Enter the number of copies using the numeric keys.
- 6 Press the [Start] key.